





Circuit-breakers, switch-disconnectors

		NZM1		Moeller HPL0211-2007-2008		http://catalog.moeller.net	
		Max. cable connection area	For use with	Terminal capacities		AWG/kcmil	
				Type of conductor			
				mm ²			
Control circuit terminal							
	–	NZM1(-4), PN1(-4), N(S)1(-4)	Three- and four-pole	Screw connection	1 × 0.75 – 2.5 2 × 0.75 – 1.5	1 × 18 – 14 2 × 18 – 16	
	–			Box terminal			
Cover							
	–	NZM1(-4), PN1(-4), N(S)1(-4)	3 pole				
	–		4 pole				
Terminal cover, knockout, not UL/CSA approved							
For box terminals							
	–	NZM1, PN1, N1	3-pole				
	–	NZM1(-4), PN1(-4), N1(-4)	4 pole				
IP2X protection against contact with a finger							
For box terminals							
	–	NZM1, PN1, N1	3 pole				
	–	NZM1(-4), PN1(-4), N1(-4)	4 pole				
For cover NZM1(-4)-XKSA or NZM1...(C)NA, N(S)1...NA							
	–	NZM1, PN1, NS1	3 pole				
	–	NZM1(-4), PN1(-4), N1(-4)	4 pole				

http://catalog.moeller.net		Moeller HPL0211-2007-2008		NZM1		xEnergy	
Part no. Article no. when ordered separately		Std. pack	Notes				
NZM1-XSTS 260150		1 off	Type contains parts for two terminal locations located at top or bottom for 3 or 4-pole circuit-breakers. Included as standard with tunnel terminal Degree of protection IP1X				
NZM-XSTK 266739		1 off	NZM-XSTK cannot be combined with NZM1(-4)-XIPK IP2X protection against contact with a finger. Height or thickness of the control terminals: NZM-XSTK = 2 mm NZM-XSTS = 2 mm				
NZM1-XKSA 260021		1 off	Type contains parts for a terminal located at top or bottom for 3 or 4-pole circuit-breakers. Protection against direct contact where cable lugs, busbars or tunnel terminals are used				
NZM1-4-XKSA 266741		1 off	Contained in kit with tunnel terminals or screw connection terminals. Degree of protection IP1X on the connection side when using insulated conductor material.				
NZM1-XKSFA 100780		1 off	Type contains parts for a terminal located at top or bottom for 3 or 4 pole circuit-breakers. Enhancement of the protection against direct contact (simple finger protection).				
NZM1-4-XKSFA 100781		1 off					
NZM1-XIPK 266744		1 off	Type contains parts for a terminal located at top or bottom for 3 or 4-pole circuit-breakers. Enhancement of the protection against direct contact to IP2X.				
NZM1-4-XIPK 266745		1 off	Protection when reaching into the cable connection area with the connection of cables in the box terminal. Cannot be combined with NZM-XSTK control circuit terminal.				
NZM1-XIPA 266748		1 off	Type contains parts for a terminal located at top or bottom for 3 or 4-pole circuit-breakers. Enhancement of the protection against direct contact to IP2X.				
NZM1-4-XIPA 266749		1 off					

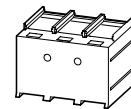
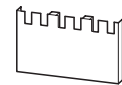
Circuit-breakers, switch-disconnectors

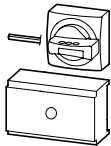
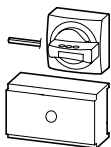
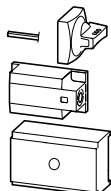
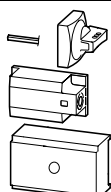

	Type	For use with	Part no. Article no. when ordered separately	Price see price list	Std. pack	
Main switch assembly kit Equipment supplied: <ul style="list-style-type: none">• Rotary door-coupling handle• NZM...-XV4 extension shaft• External warning plate/designation label in German/English• Black and yellow flash For enhanced protection against direct contact on the incomer side, IP2X protection against contact with a finger can be ordered → 10/49 Other external warning plates/designation labels can be clipped on.						
With black door coupling rotary handle						
	Lockable on the 0 position on the handle using up to 3 padlocks, can also be modified for the I position. With door interlock.		NZM1(-4) PN1(-4), N(S)1(-4)	NZM1-XHB 266626	1 off	
			NZM2(-4) PN2(-4), N(S)2(-4)	NZM2-XHB 266627		
			NZM3(-4) PN3(-4), N(S)3(-4)	NZM3-XHB 266628		
			NZM4(-4) N(S)4(-4)	NZM4-XHB 271779		
With red door coupling rotary handle for using switch as Emergency-Stop device according to IEC/EN 602041, VDE 0113 Part 1						
	Lockable on the 0 position on the handle using up to 3 padlocks. Lockable door as additional feature, locking facility on circuit-breaker in 0 position.		NZM1(-4) PN1(-4), N(S)1(-4)	NZM1-XHBR 266632		
			NZM2(-4) PN2(-4), N(S)2(-4)	NZM2-XHBR 266633		
			NZM3(-4) PN3(-4), N(S)3(-4)	NZM3-XHBR 266634		
			NZM4(-4) N(S)4(-4)	NZM4-XHBR 271842		
Main switch assembly kit for side panel mounting Actuation of the switch on the control panel side wall Switch mounting on mounting plate Equipment supplied: <ul style="list-style-type: none">• Door coupling rotary handle• NZM...-XV4 extension shaft• External warning plate/designation label in German/English• Black and yellow flash For enhanced protection against direct contact on the incomer side, IP2X protection against contact with a finger can be ordered → 10/49 Other external warning plates/designation labels can be clipped on.						
Standard, black/grey						
	Lockable on the 0 position on the handle using up to 3 padlocks, can also be modified for the I position.	For operation on the left	NZM1(-4) PN1(-4), N(S)1(-4)	NZM1-XS-L 266641	1 off	
			NZM2(-4) PN2(-4), N(S)2(-4)	NZM2-XS-L 266642		
			NZM3(-4) PN3(-4), N(S)3(-4)	NZM3-XS-L 266643		
			NZM4(-4) N(S)4(-4)	NZM4-XS-L 289806		
		For operation on the right	NZM1(-4) PN1(-4), N(S)1(-4)	NZM1-XS-R 266644		
			NZM2(-4) PN2(-4), N(S)2(-4)	NZM2-XS-R 266645		
			NZM3(-4) PN3(-4), N(S)3(-4)	NZM3-XS-R 266646		
			NZM4(-4) N(S)4(-4)	NZM4-XS-R 289807		
Red-yellow for Emergency-Stop						
	Lockable on the 0 position on the handle using up to 3 padlocks.	For operation on the left	NZM1(-4) PN1(-4), N(S)1(-4)	NZM1-XSR-L 266653		
			NZM2(-4) PN2(-4), N(S)2(-4)	NZM2-XSR-L 266654		
			NZM3(-4) PN3(-4), N(S)3(-4)	NZM3-XSR-L 266655		
			NZM4(-4) N(S)4(-4)	NZM4-XSR-L 289808		
		For operation on the right	NZM1(-4) PN1(-4), N(S)1(-4)	NZM1-XSR-R 266656		
			NZM2(-4) PN2(-4), N(S)2(-4)	NZM2-XSR-R 266657		
			NZM3(-4) PN3(-4), N(S)3(-4)	NZM3-XSR-R 266658		
			NZM4(-4) N(S)4(-4)	NZM4-XSR-R 289809		

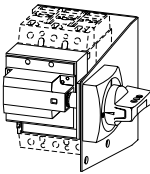
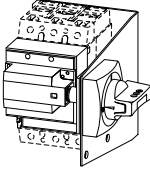
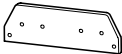

Type	For use with	Part no. Article no. when ordered separately	Price see price list	Std. pack	
Main switch assembly kit for side panel mounting with mounting bracket					
For direct mounting of circuit-breaker and handle in the side wall of the control cabinet Equipment supplied: <ul style="list-style-type: none">• Door coupling rotary handle• Mounting bracket• Special short extension shaft• External warning plate/designation label in German/English• Black and yellow flash For enhanced protection against direct contact on the incomer side, IP2X protection against contact with a finger can be ordered → 10/49 Other external warning plates/designation labels can also be clipped on.					
Standard, black/grey					
	Can be locked in 0 position, with adequate modification also in I position. Narrowest minimum clearance between enclosure side plates of control panel and circuit-breaker is defined by mounting bracket. Extensions cannot be used.	For operation on the left	NZM1(-4) PN1(-4), N(S)1(-4)	NZM1-XSM-L 266663	1 off
		For operation on the left	NZM2(-4) PN2(-4), N(S)2(-4)	NZM2-XSM-L 266664	
		For operation on the right	NZM1(-4) PN1(-4), N(S)1(-4)	NZM1-XSM-R 266665	
		For operation on the right	NZM2(-4) PN2(-4), N(S)2(-4)	NZM2-XSM-R 266666	
Red-yellow for Emergency-Stop					
	Lockable in 0 position on handle. Narrowest minimum clearance between enclosure side plates of control panel and circuit-breaker is defined by mounting bracket. Extensions cannot be used.	For operation on the left	NZM1(-4) PN1(-4), N(S)1(-4)	NZM1-XSRM-L 266671	1 off
		For operation on the left	NZM2(-4) PN2(-4), N(S)2(-4)	NZM2-XSRM-L 266672	
		For operation on the right	NZM1(-4) PN1(-4), N(S)1(-4)	NZM1-XSRM-R 266673	
		For operation on the right	NZM2(-4) PN2(-4), N(S)2(-4)	NZM2-XSRM-R 266674	
Add-on plate					
For fitting to the mounting bracket when using N conductor or PE conductor terminals K25, K50, K95 or K150.					
		NZM1(-4), PN1(-4), N(S)1(-4) NZM2(-4), N(S)2(-4)	NZM1/2-XZB 266676	1 off	

Additional terminal arrangement for side wall operator with mounting bracket
 NZM1-XS(R)M-..., NZM2-XS(R)M-...
 Additional terminals K25, K50, K95, K150 → 10/99

Actuation:

3 pole

4 pole

For operation on the right

For operation on the left

For operation on the right

For operation on the left

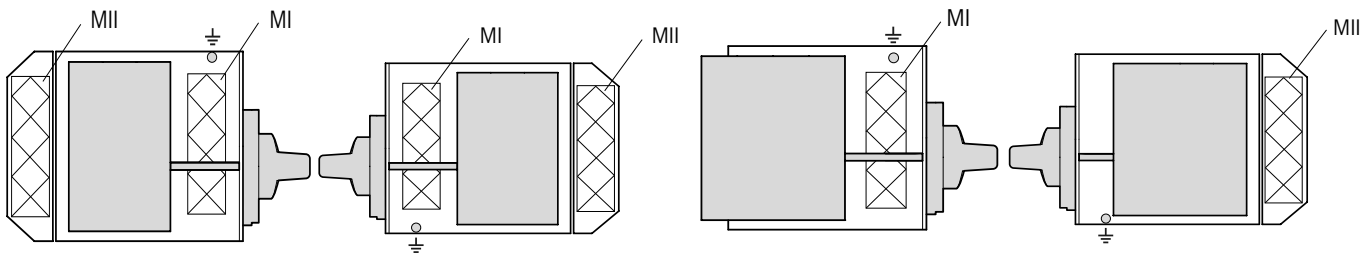

Mounting areas		MI				MII	
Variation options		V1	V2	V3	V4	V1	V2
Maximum number of additional terminals	K25	2 ×	—	—	—	—	—
	K50	—	2 ×	—	—	—	—
	K95	—	—	1 ×	—	1 ×	—
	K150	—	—	—	1 ×	—	1 ×

Example: In mounting area MI, variation option 1 allows the K25 additional terminal to be mounted twice.



Main switch assembly kit for side panel mounting

NZM1-XS(R)-L

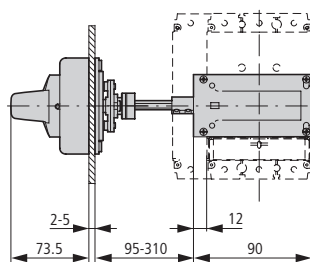

NZM1-XS(R)-R

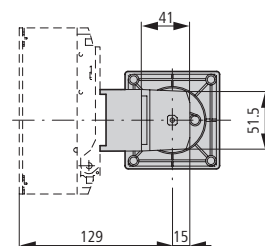
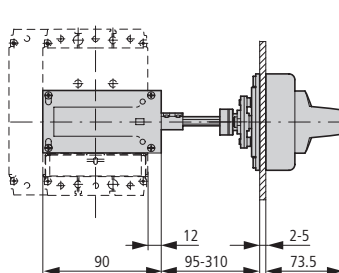

Main switch assembly kit for side panel mounting with mounting bracket

NZM1-XS(R)M-L

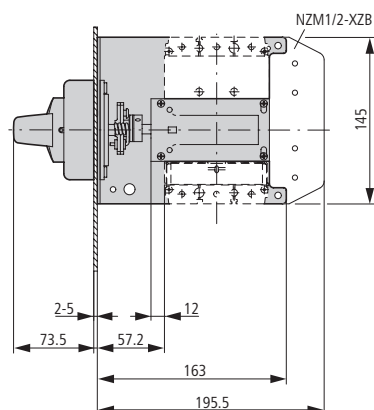

NZM1-XS(R)M-R

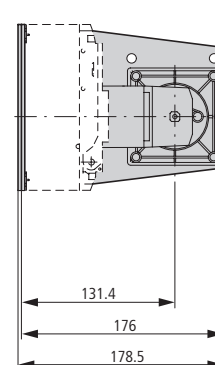
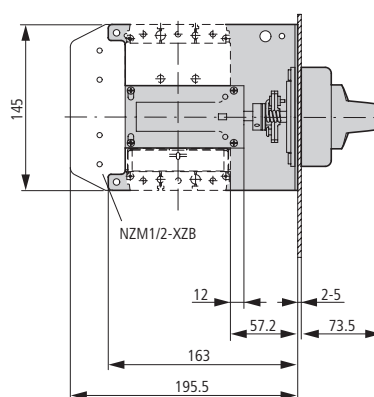

Undervoltage release

Shunt release

Early-make auxiliary contacts

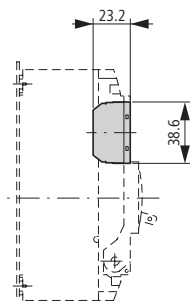
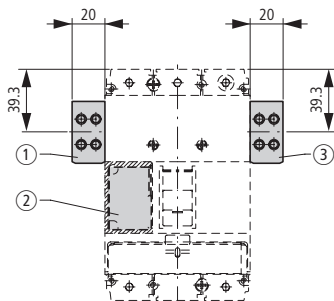

- ① NZM1-XA(HIV)
NZM1-XU(HIV)(20)
NZM1-XHIV
- ② NZM1-XA(HIV)(L)
NZM1-XU(V)(HIV)(L)(20)
NZM1-XHIV(L)
- ③ NZM1-XHIVR

Spacers

NZM1/2-XAB

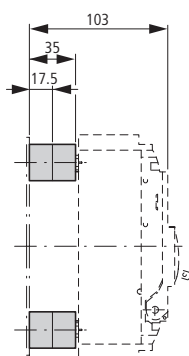

Clip plate

NZM1-XC35

